

Careful heart

Full heart

Sincere heart

Relieved heart

Save-worry heart

Comfy heart

One hundred percent authentic manufacturer, more than 10 years experience in production of led light  
With excelsior attitude, we aim to offer perfect product, as we believe vitality of a enterprise is depends on quality of product  
5 years warranty, release innovative, reliable and high-performance LED light regularly  
We care and take care of every inquiry, feedback and complaint of customers  
Customer is partner, we pursuit profit, value and development with partner together

SD- C Serie

Product Features

SUPER HIGH PERFORMANCE PRICE RATIO  
DESIGN A LAMP,ILLUMINATE A CITY  
MULTIPLE APPLICATIONS, SD-C SERIES TUNNEL LIGHT  
Applied for tunnel lighting, projection lighting, city decorative lighting, construction lighting, ads lighting.  
Body powder baking process ,Color bright and long time does not change color .Better protection and not easy to be corrosion , IP grade up to IP66/IP67



MODEL NO: LX-GL4X  
(200W)

LED QTY: 96 PCS  
Packing Type: 1 unit(s)/ctn  
Packing Dimension: 51.5\*39.5\*19.5 cm  
NW: ≈6.1 kg  
GW: ≈7.6kg

BRIDGELUX : 200W

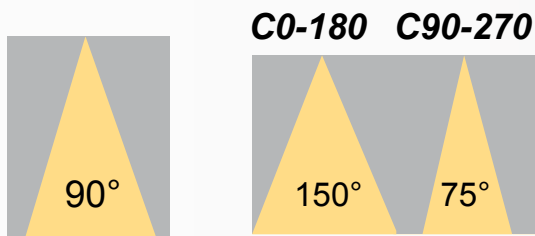

LED By: BRIDGELUX

Powered By: MW MEAN WELL



347-480V

AC

47-63HZ

90-305V

AC

47-63HZ

>0.95

PF

<15%

THD

10-28V

DC

380k~850K

λ

LM79

IES LED

indoor

IK10

shockproof

CLASS I

dimmable

CE

EURO

FC

EURO

RoHS

EURO

warranty

Working Temperature: -40-50°C Working Humidity: 10%~95%RH Best Working Temperature: -20 C ~+30°C Storage Temperature: -40 C ~+80 C



PURE ALUMINUM MATERIAL  
WHOLE BODY HEATSINK

The pure aluminum housing is nice looking and durable, lighting source contact the heatsink directly .Compared to traditional LED heatsink, our dissipating area is bigger. It is perfect LED heatsink solution.

Prospective design, performance excellencea (followings are abbreviated drawing, different watts, same functions)



Corrosion resistance

The whole lamp with the powder coating is brighter, without fading and corrosion , Suitable for harsh outdoor environment.



3-d Heat Dissipation

Professional thermal structure, cross-ventilation design improving heat dissipation performance to long life time



Large angle adjustment

Screw lock attached type installation, multiple stents to adjust, adjustable Angle of 315 ° , into light Angle can be adjust at will.



Protection rate:IP67

By using water-proof connecotr and silicon rubber sealing,the protection rate can achieve IP67,meeting the requirement for harsh,tough environment

Configured with a multitude of lens



Adaptive to BRIDGELUX 45mil  
High Power LED (ILA5)

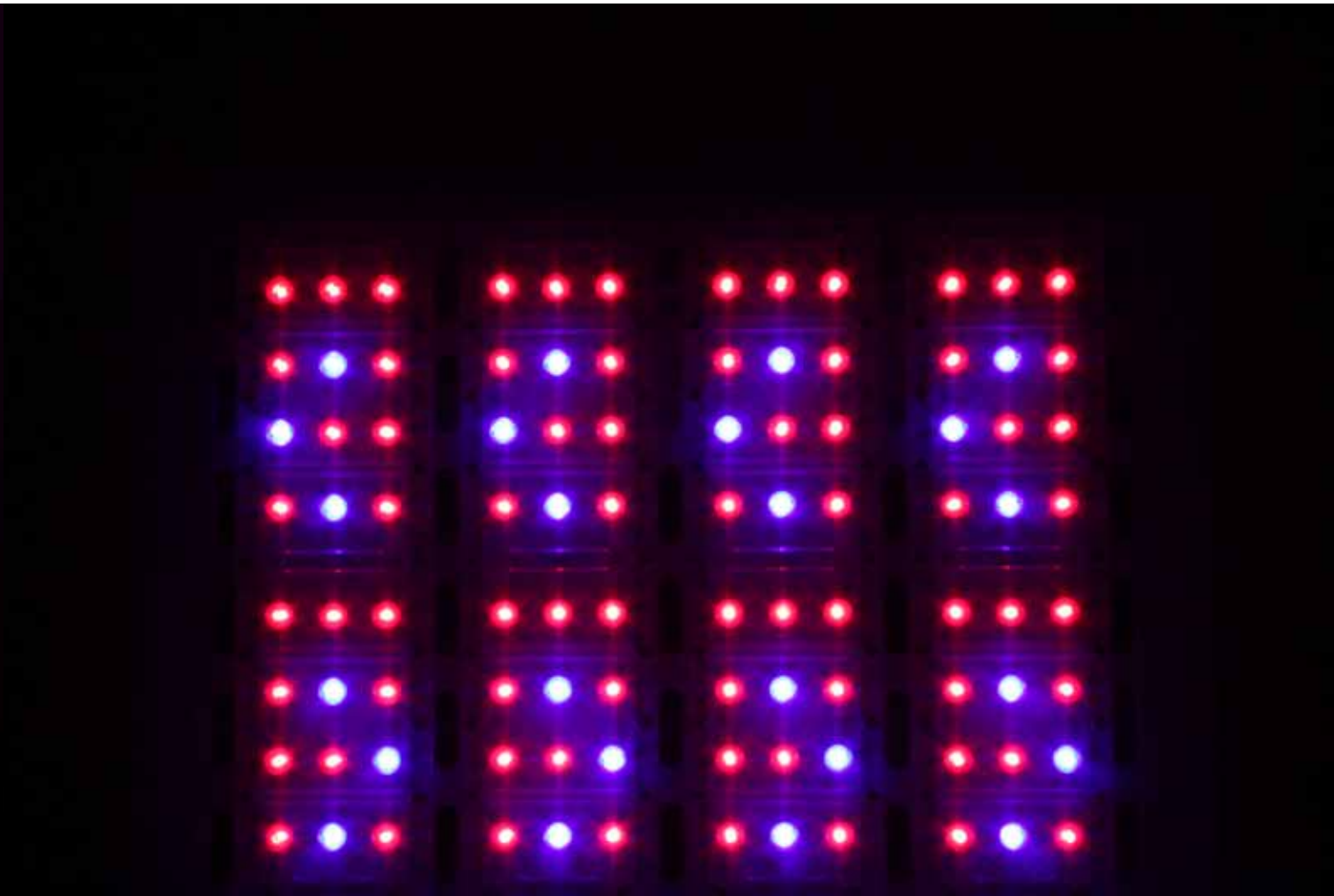
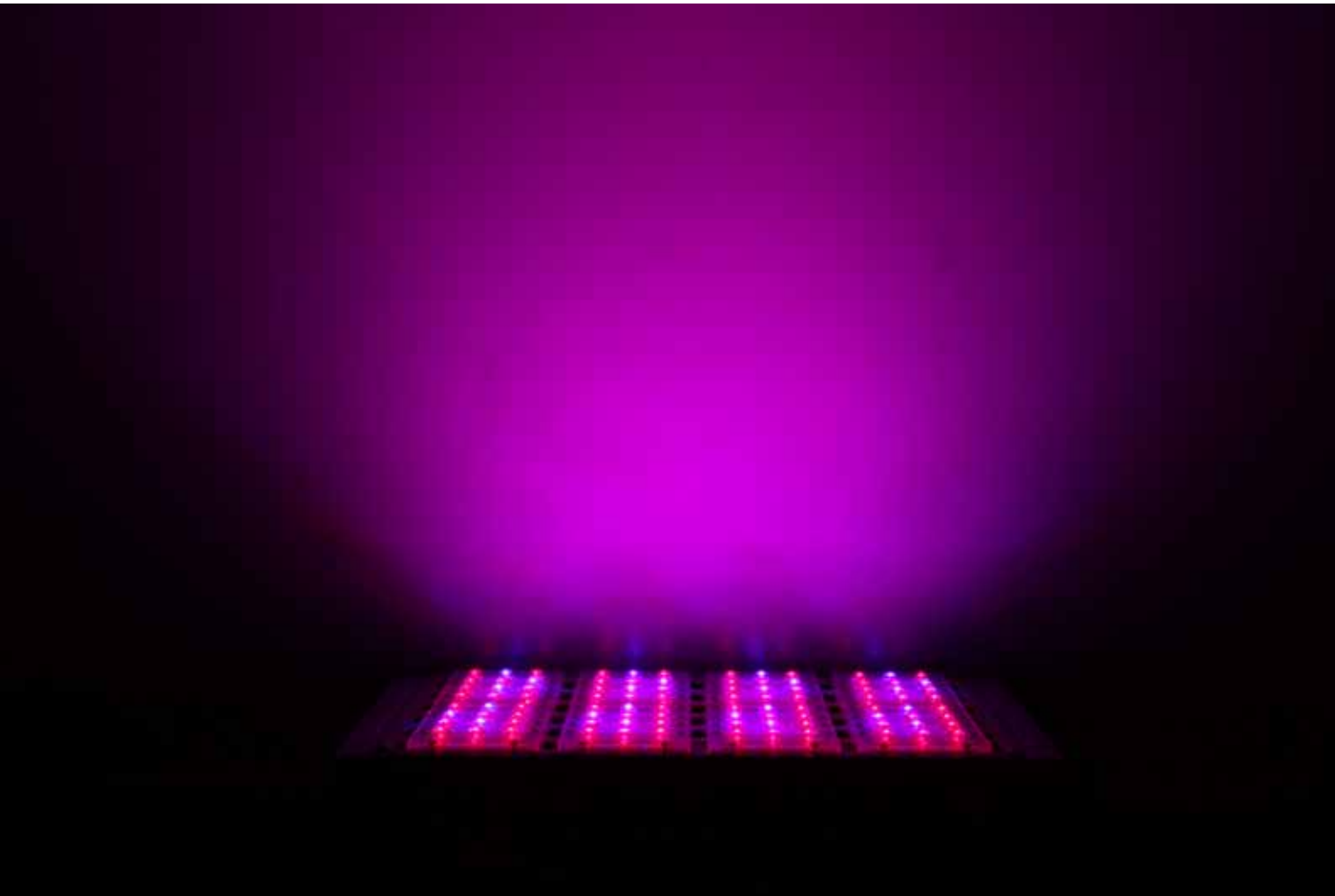

Design Innovation, Cost-Performance Stamping process, high production efficiency guarantees shortest lead time, good heat dissipation performance, lighting weight, easy assembly and cost effective.

Comparison chart of production efficiency

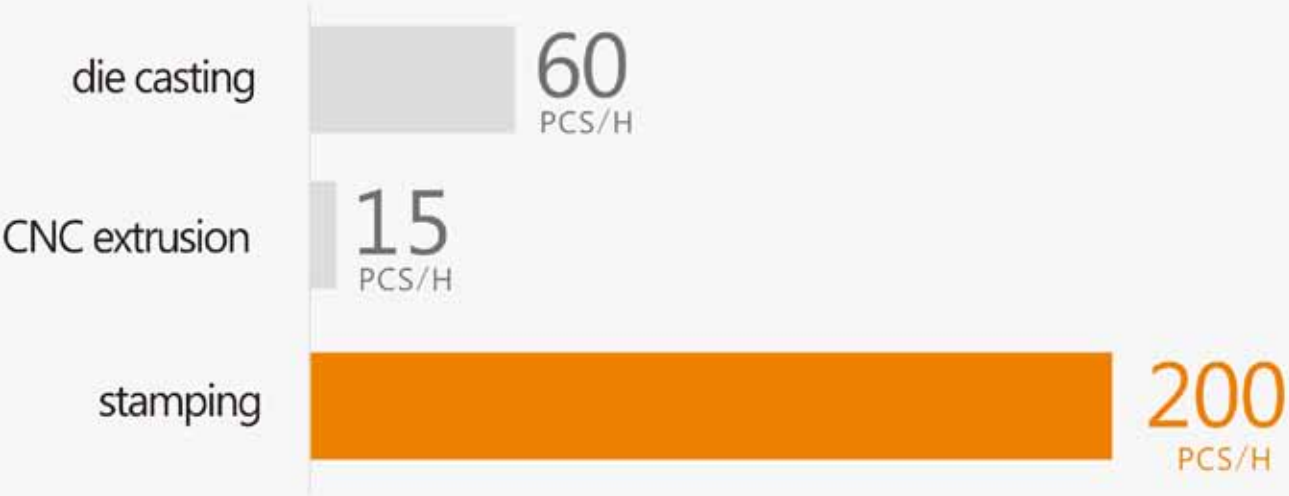

Comparison chart of heat conductivity coefficient

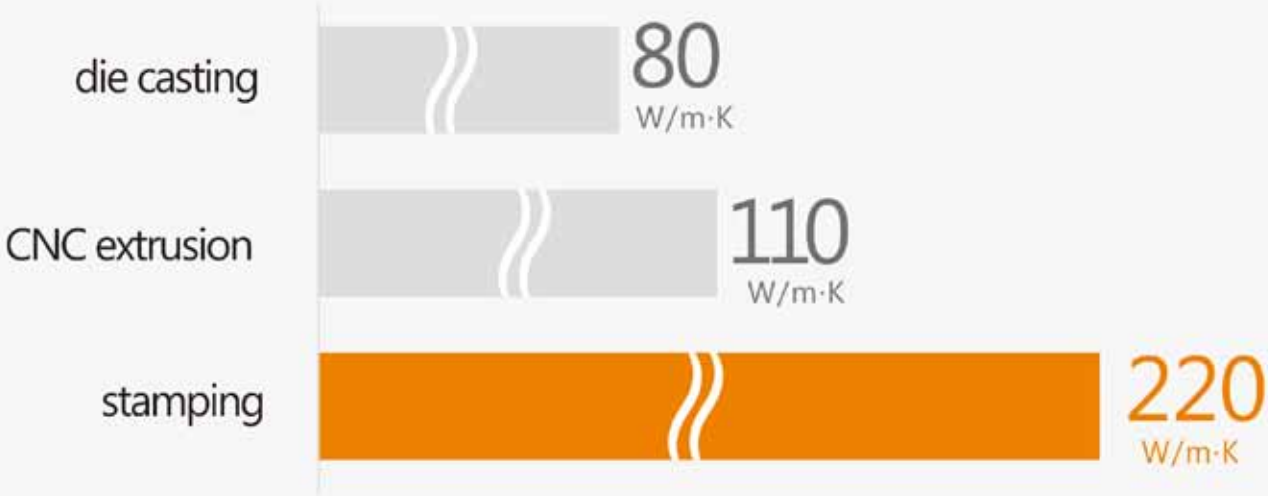



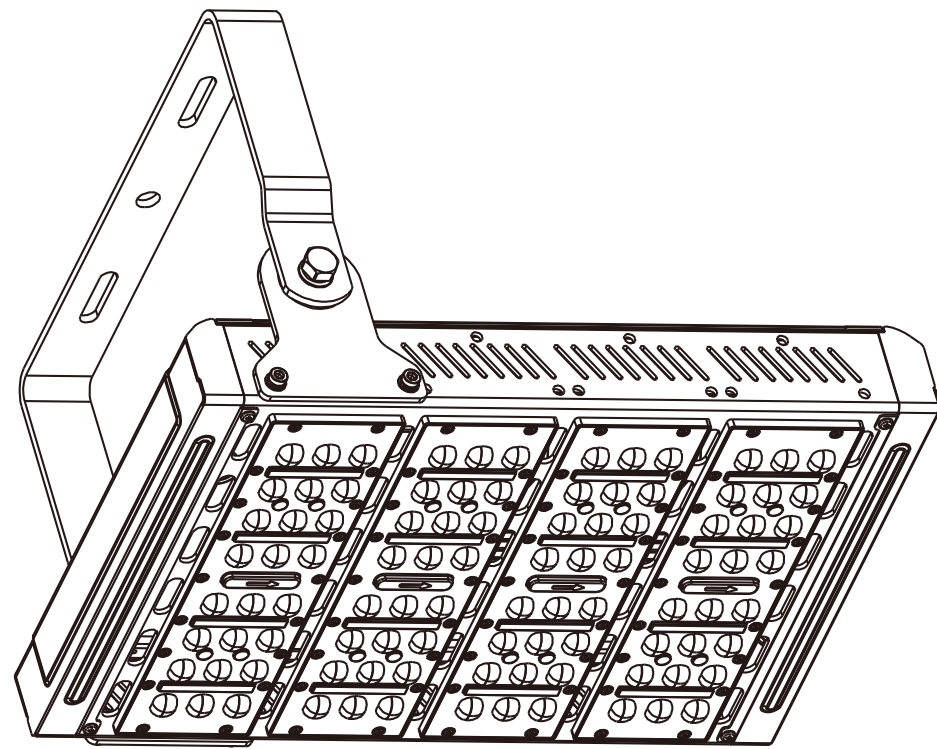
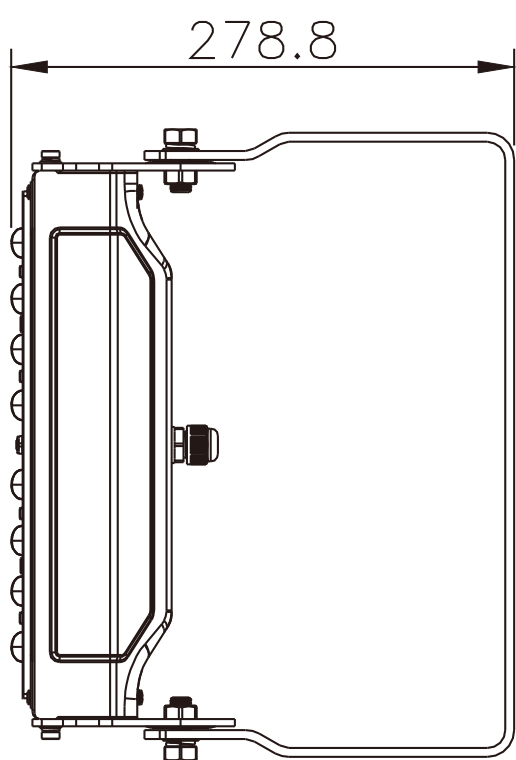
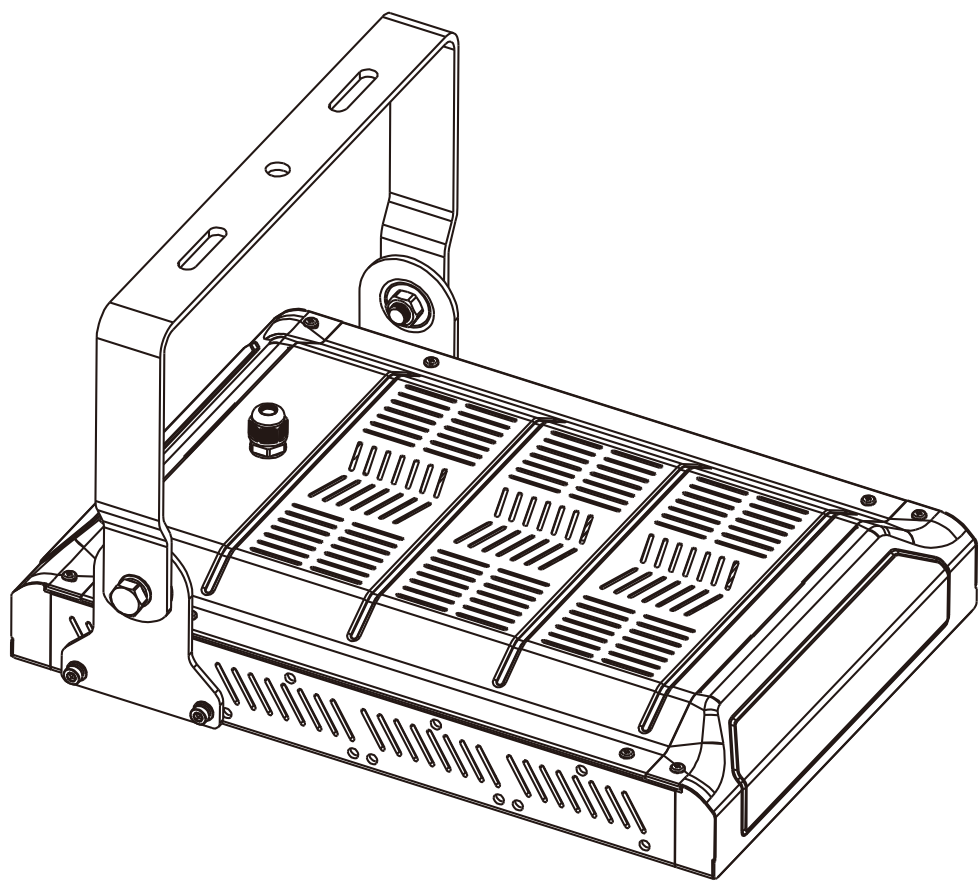
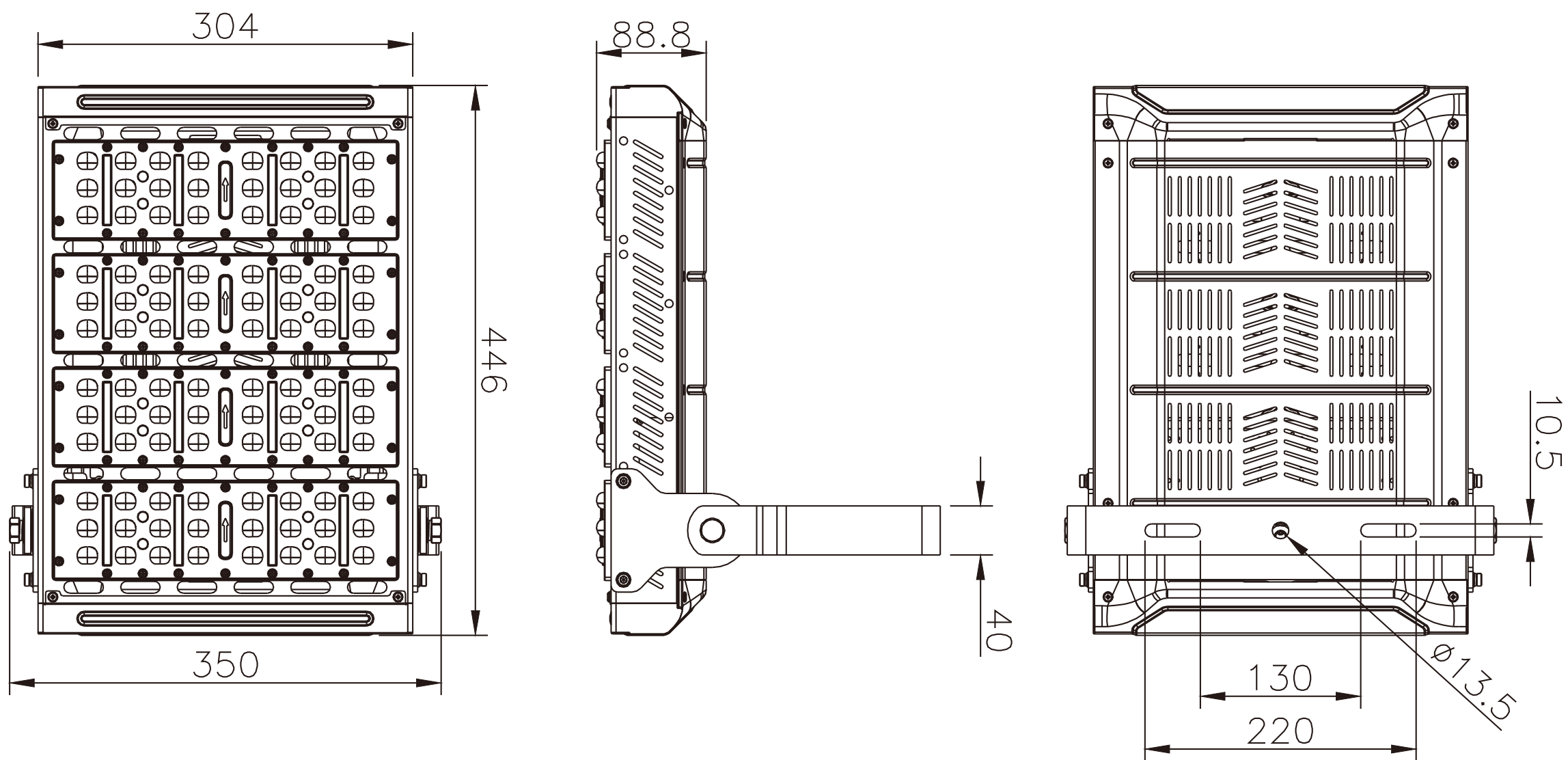

LX-GL4X

LED CHIP MODEL

POWER

Light source



>100lm/ W  
28W

